

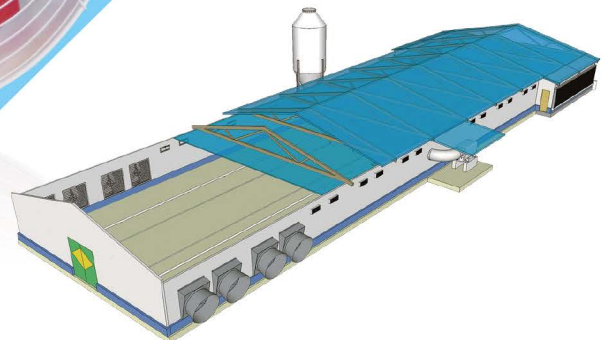

Extreme Energy Saving
Intelligent Fan
For Agriculture-Pasturage



Blue Energy Saving Technology



bigbest solution Inc.
www.bigbest.com.tw

Extreme Energy Saving

biggest Your Best Choice!

Analysis of electricity consumption

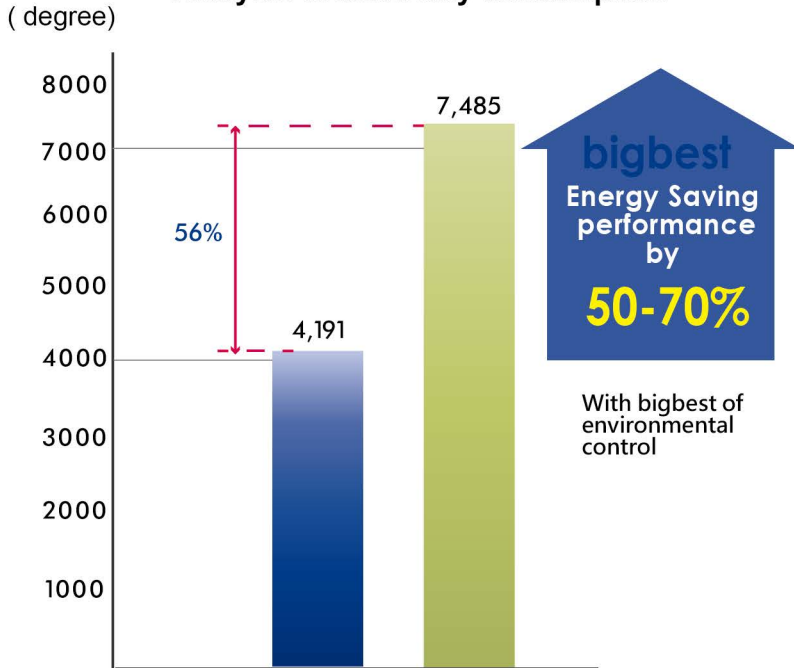

For example, the actual use of livestock in Taiwan.

	biggest	Competitors
Outdoor Temperature	35°C	35°C
Indoor Temperature + Cooling Pad	28°C	28°C
Indoor Temperature + Exhaust fan	30°C	31°C

Power consumption test results for 64 days(Kwh)

- Competitors (Other of environmental control)
- With biggest of environmental control

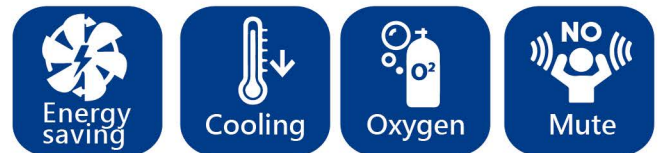

Fan spec: Frame – 50” FRP blade

Assuming each livestock requires 6pcs of fans, our intelligent fan can well control the air flow but the traditional one can only control air flow by turning on/off.

Demand Wind Flow(CMH)	264,000	176,000	50,000
Traditional Fan Input Power (W)	Turn on 6 fans : 1,500x6=9,000W	Turn on 4 fans : 1,500x4=6,000W	Turn on 2 fans : 1,500x2=3,000W
Intelligent Fan Input Power (W)	6 fans at 550rpm : 1,055x6=6,330W	6 fans at 400rpm : 470x6=2,820W	6 fans at 250rpm : 115x6=690W
Power Saving Rate	30%	53%	77%

※ The above product spec is for reference only, please refer to actual product if any inconsistency.



Intelligent motor

Traditional motor

Extreme energy-saving

- Direct drive
- Automatic speed control
- Reduce staff management costs
- High security, Protection mechanism
- Low material costs
- Quiet and Low noise
- Longevity, Low failure rate
- High Efficiency, Low Temperature rising

No belt drive, fan is mounted directly on the motor.	Supplies	Belt structure, need to replace the belt.
No power consumption, strong wind speed.	Effectiveness	Power consumption is high, the wind speed is insufficient.

Directly connected FRP fan

Fan material : Fiber reinforced plastics

50" 36" 30"



Standard

	Fan Dimension (CM)	Air Flow (m ³ /h)	Revolution (RPM)	Blade Diameter (CM)	Motor	Blade material
Standard	146x146	44,000	550	50" (125)	850W	Nylon fiber
	146x146	48,000	630	50" (125)	1200W	Nylon fiber
Standard	106x106	24,000	560	36" (91)	550W	Nylon fiber
	106x106	33,000	830	36" (91)	1200W	Nylon fiber
	85x85	13,000	685	30" (76)	375W	Fiber reinforced plastics

Directly connected Galvanized / stainless steel fan

50"

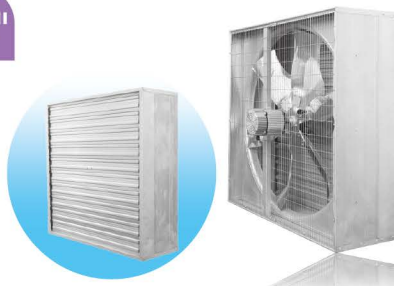

Fan material : Galvanized steel / Stainless steel

	Fan Dimension (CM)	Air Flow (m ³ /h)	Revolution (RPM)	Blade Diameter (CM)	Motor	Blade material
	138x138	44,000	425	50" (125)	1200W	Stainless steel

Directly connected Galvanized steel fan

24"



Fan material : Fiber reinforced plastics

	Fan Dimension (CM)	Air Flow (m ³ /h)	Revolution (RPM)	Blade Diameter (CM)	Motor	Blade material
	75x75	11,000	1,100	24" (61)	375W	Fiber reinforced plastics

※ The above product spec is for reference only, please refer to actual product if any inconsistency.



bigbest

Exhaust fan + Cooling pad
= Ventilation cooling system



Extreme Energy Saving

It is publicly known as the most energy efficient and cost effective cooling and ventilation appliance in the world.

The most durable

Lowest maintenance cost among all cooling systems.

The best effect

It helps to reduce the temperature and exhaust smoke / dust quickly even in an extremely hot environment.

Good air quality

Multi-functions for ventilation, air change and oxygen content increase in order to serve the purpose of better air quality.

Raise competitiveness

Improve the factory environment and increase employee motivation. It can also help to increase productivity and prevent infections.

Ventilation cooling system

Factory

Our solution is designed to improve comfort with lower cost, reduce temperature fluctuations, control humidity and improve working condition for employees.

Livestock

With lower cost of ownership, our solution enables farms to operate and produce under optimum conditions for hatching and raising.

Greenhouse

Our solution can help the greenhouse growers to operate and produce under optimum conditions with lower cost and energy consumption.

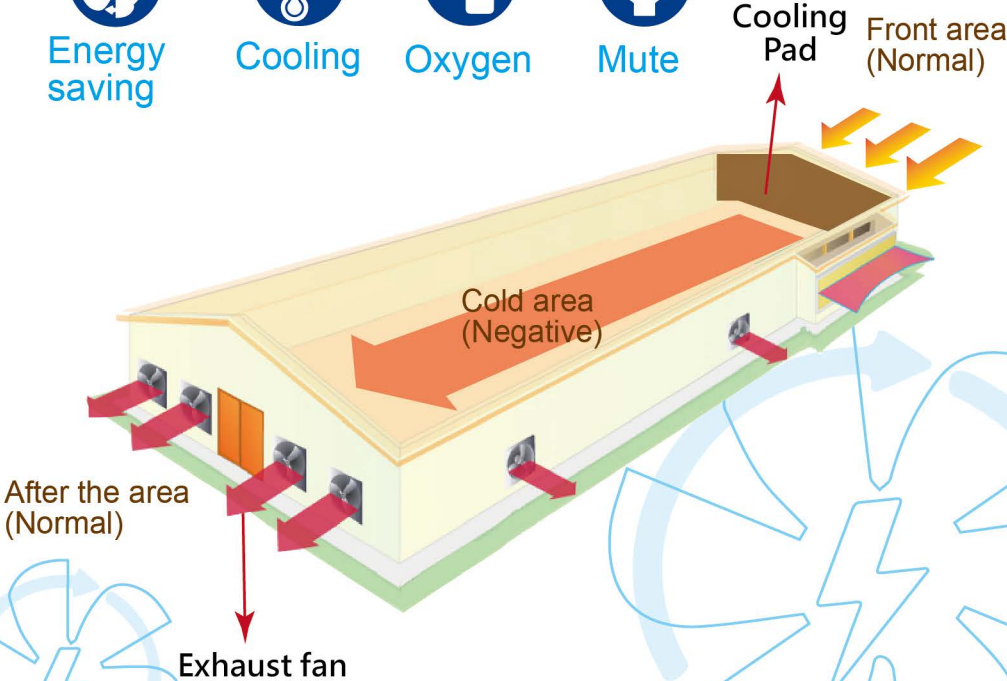

www.bigbest.com.tw



bigbest

Intelligent Livestock Temperature Controller

● Environmental Change Analysis

Indoor environment by monitoring temperature changes, humidity, air quality and other environmental parameters, and automatic control equipment for fine-tuning. It monitors indoor temperature, environmental changes for the plant to create the best value for the environment.

- Temperature sensor, humidity sensor device, power failure alarm (at the same time standby failure, high and low temperature alarm function), fan, small window, Cooling Pad.



www.bigbest.com.tw

Basic Environment Controller

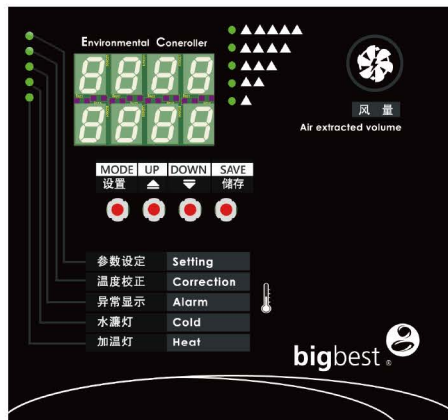

The use of standard livestock environmental requirements, high-tech design; The chip can store a variety of work procedures. Can according to the set to control the transverse variable speed wind machine, vertical cooling fan, water curtain pump and winter heating equipment environment adjusting device is opened and closed, automatic ammonia discharge, supplementary fresh air, heat preservation.

Basic Function

- Advanced microcomputer control program.
- Can set the starting temperature, control cooling pad, water pump, control the wind speed of the fan, the temperature and humidity control in a set curve of the environmental.
- Intermittent working time.
The temperature is lower than the temperature set by the thermostat, the fan isn't working, can be used to run the fan intermittent ventilation, can control the temperature inside to avoid condensation pressure is low-oxygen phenomenon.
- In the high temperature, low temperature, sensor failure, power short circuit, the alarm output.
- In the basic functions, can control more than Bigbest Extreme Energy Saving fans. Through the temperature settings, the fan can be automatically changed with temperature and speed, to meet the temperature requirements within the livestock .

Mainly Used in :

Factory, livestock , breeding farm, farms, farm nursery, improving air quality, eliminate ammonia place.





Livestock
Energy saving · Cooling · Oxygen · Mute
Completely resolved



www.bigbest.com.tw

